

TOWN SQUARE



Northwest corner of Lockport Street & Wood Farm Road, Plainfield, IL

SITE FEATURES

- Across from Plainfield's Village Hall & Settlers Park
- Convenient Downtown Location
- Traffic Counts: 23,000 ADT Lockport Street
- Walking Traffic in area
- Excellent Demographics
 - 2005 Special Census 30,314 population
 - Plainfield has the 2nd fastest growth rate in Illinois
 - Average Household Income \$93,335 (2004)

BUILDING FEATURES

- New Construction
- Individual Heating and Air Conditioning per unit
- Landlord Build-out Available
- Flexible Spaces Available:
 - 1st Floor Retail 1,500 SF to 12,153 SF
 - 2nd Floor Professional Office 720 SF to 13,695 SF



DEVELOPED & LEASED BY:

PLAINFIELD VILLAGE SQUARE, LLC.

(815) 609-8000 phone · (815) 609-8100 fax

TOWN SQUARE

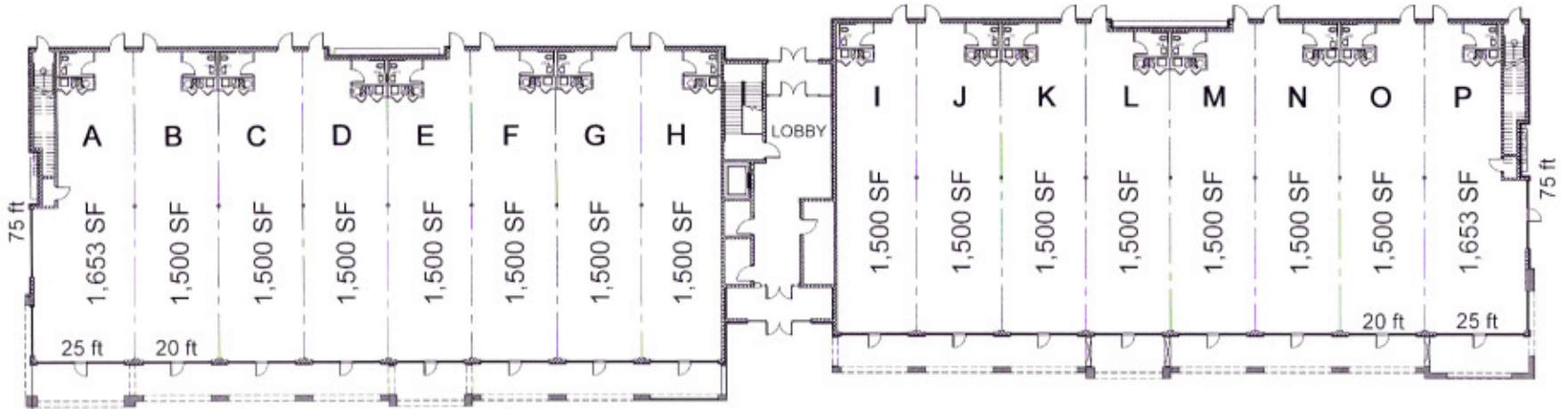

FIRST FLOOR RETAIL FLOOR PLAN

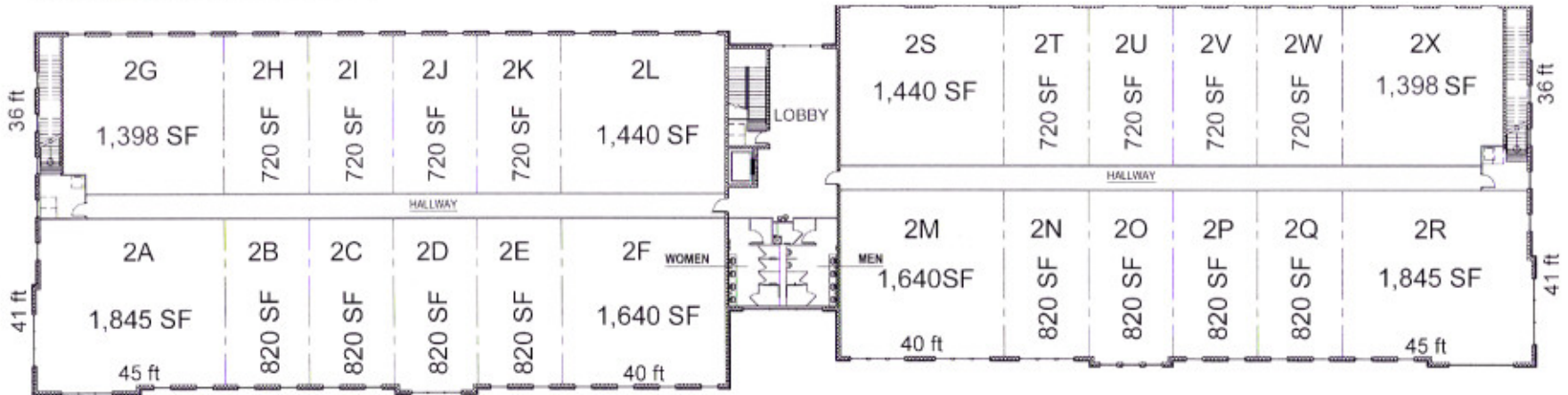

SECOND FLOOR PROFESSIONAL OFFICE FLOOR PLAN

DEVELOPED & LEASED BY:

PLAINFIELD VILLAGE SQUARE, LLC.

(815) 609-8000 phone · (815) 609-8100 fax